

- GENERAL NOTES:

1. SIDEWALK CROSS SLOPE TO BE 1.5% TOWARD THE ROADWAY UNLESS NOTED OTHERWISE.
2. THE LONGITUDINAL SLOPE OF THE SIDEWALK SHALL NOT EXCEED 8.33%.
3. ADJUST ALL B-BOXES ENCOUNTERED IN APPROACH OR PATH OF PROPOSED SIDEWALK TO MATCH PROPOSED GRADE. B-BOX ADJUSTMENTS SHALL BE SLEEVED WITH A 4" ADS COUPLING.
4. PROVIDE TREE ROOT PRUNING WHERE TREE CANOPIES ARE WITHIN LIMITS OF PROPOSED SIDEWALK. TREE ROOT PRUNING SHALL BE CONSIDERED INCIDENTAL TO THE COST OF THE CONTRACT
5. PROPOSED SIDEWALK SHALL TIE INTO EXISTING SIDEWALK OR DRIVEWAYS AS APPLICABLE
6. LANDSCAPE RESTORATION ADJACENT TO PROPOSED SIDEWALK SHALL HAVE A MAXIMUM WIDTH OF 4' OR TO THE NEAREST PROPERTY LINE, WHICHEVER IS CLOSER.
7. PROVIDE TREE PROTECTION PER CITY STANDARDS FOR TREES IN THE ROW.
8. SIDEWALK CURB IS INCIDENTAL TO THE PCC SIDEWALK QUANTITY.
9. ADJUSTMENT OF B-BOXES ARE INCIDENTAL TO THE PCC SIDEWALK QUANTITY.

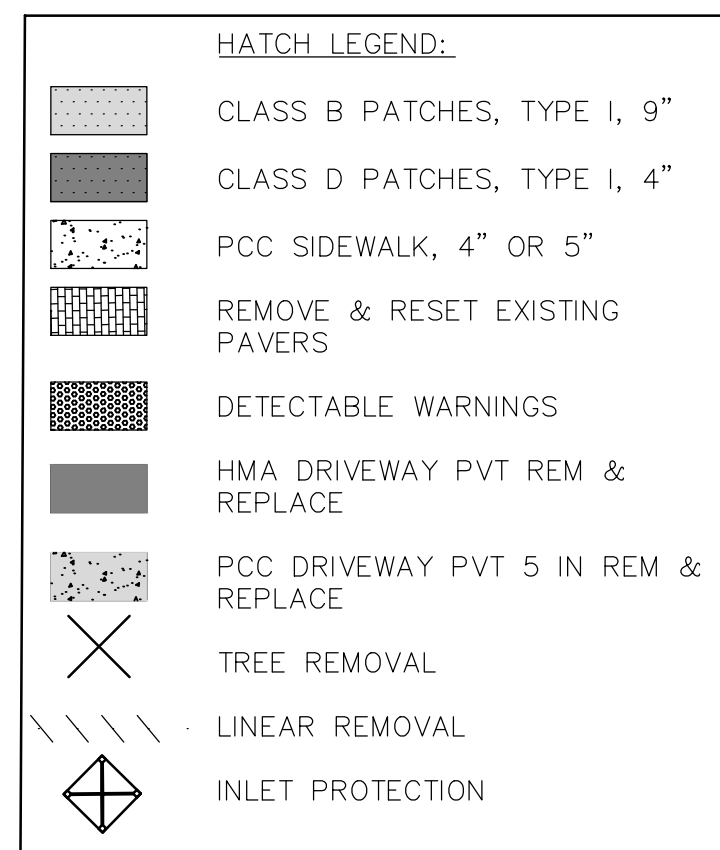
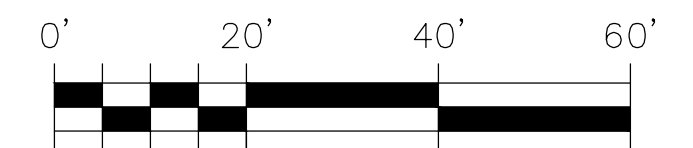
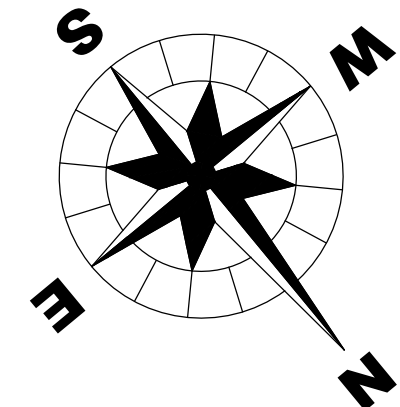

DESIGN PLAN NOTE:

1. EXISTING CONDITIONS FOR KINGSTON STREET ARE AN APPROXIMATION BASED ON AERIAL PHOTO INFORMATION, DUPAGE COUNTY GIS PARCEL INFORMATION, AND USGS 1' CONTOUR TOPOGRAPHY. ACTUAL SITE CONDITIONS TO BE FIELD VERIFIED PRIOR TO CONSTRUCTION.

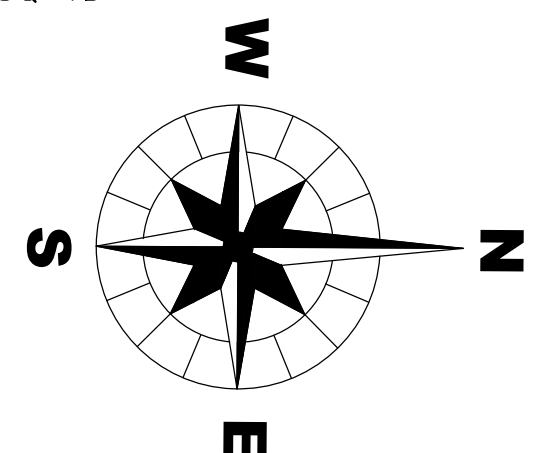
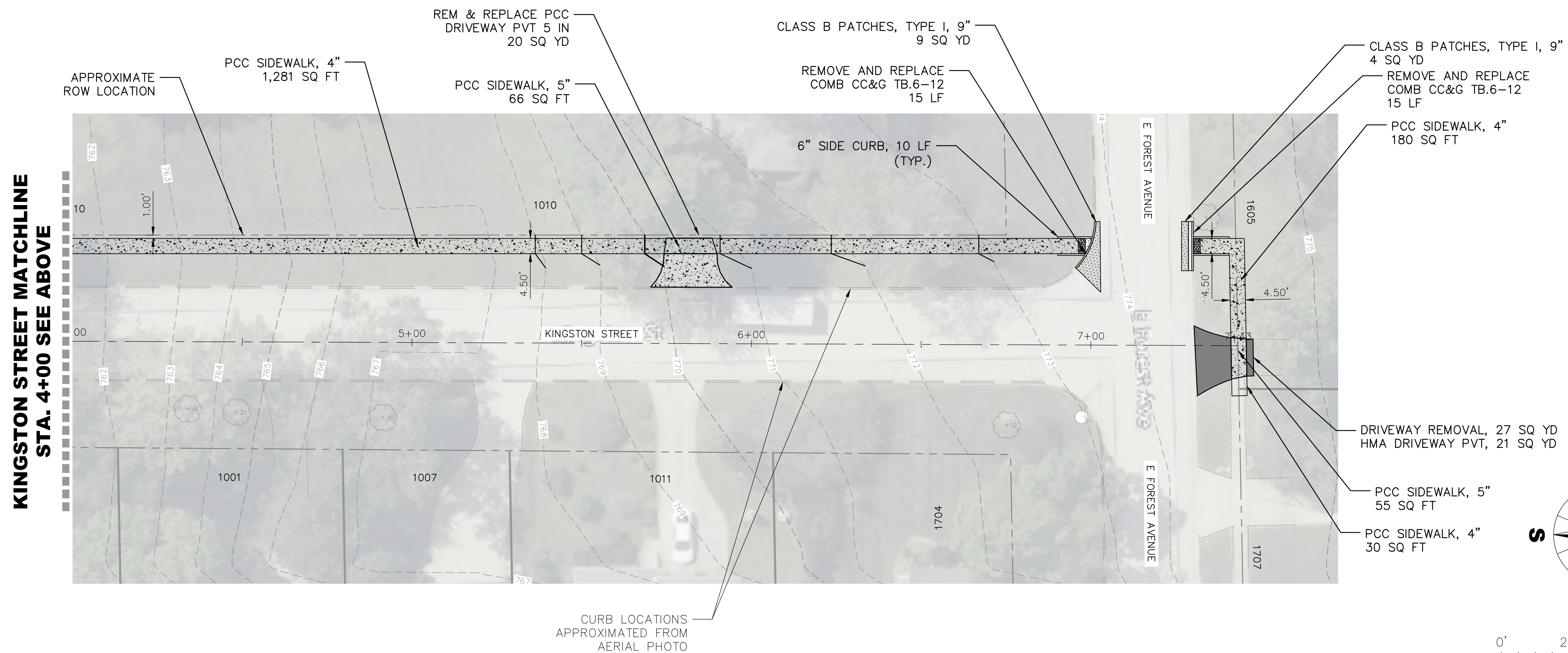

**WHEATON 2025 FALL  
SIDEWALK PROGRAM -  
SECTION 1**

[illegible]

**CITY OF WHEATON  
303 W. WESLEY STREET  
WHEATON, IL 60187  
630-260-2000**

**WBK ENGINEERING, LLC**  
1116 WEST MAIN STREET, SUITE 201  
ST. CHARLES, ILLINOIS 60174  
(630) 443-7755



PROJECT NO. 252008

DATE : 04/04/25

DRAWING NO. **SP1**

SHEET:

**1 OF 5**

UPDATED: 4/8/2025 - ADAMGIAZZON