

GENERAL NOTES

1. SIDEWALK CROSS SLOPE TO BE 1.5% TOWARD THE ROADWAY UNLESS NOTED OTHERWISE.
2. THE LONGITUDINAL SLOPE OF THE SIDEWALK SHALL NOT EXCEED 8.33%.
3. ADJUST ANY B-BOXES ENCOUNTERED IN APPROACH OR PATH OF PROPOSED SIDEWALK TO MATCH PROPOSED GRADE. B-BOX ADJUSTMENTS SHALL BE SLEEVED WITH A 4" ADS COUPLING.
4. PROVIDE TREE ROOT PRUNING WHERE TREE CANOPIES ARE WITHIN LIMITS OF PROPOSED SIDEWALK. TREE ROOT PRUNING SHALL BE CONSIDERED INCIDENTAL TO THE COST OF THE CONTRACT.
5. PROVIDE TREE BRANCH AND BRUSH PRUNING AS NEEDED FOR SIDEWALK ACCESSIBILITY. TREE BRANCH AND BRUSH PRUNING SHALL BE CONSIDERED INCIDENTAL TO THE COST OF THE CONTRACT.
6. DRIVEWAYS ON THIS STREET SHALL UTILIZE 3' FLARES.
7. WHERE PROPOSED DRIVEWAY FLARES EXTENDS PAST EXISTING DEPRESSED CURB AND GUTTER PROPOSED CURB AND GUTTER SHALL BE INSTALLED TO MATCH THE LIMITS OF THE DRIVEWAY APRON.
8. PROPOSED SIDEWALK SHALL TIE INTO EXISTING SIDEWALK OR DRIVEWAYS AS APPLICABLE.
9. LANDSCAPE RESTORATION ADJACENT TO PROPOSED SIDEWALK SHALL HAVE A MAXIMUM WIDTH OF 4' OR TO THE NEAREST PROPERTY LINE, WHICHEVER IS CLOSER.
10. MAXIMUM DRIVEWAY SLOPES SHALL BE 12% PER CITY CODE. DRIVEWAYS THAT EXCEED 12% WILL UTILIZE A 2" MOUNTABLE CURB PAID AS COMBINATION CONCRETE CURB AND GUTTER TYPE M-2.12 TO IMPROVE DRIVEWAY GRADES. A NOMINAL QUANTITY HAS BEEN ADDED TO ALL LOCATIONS.

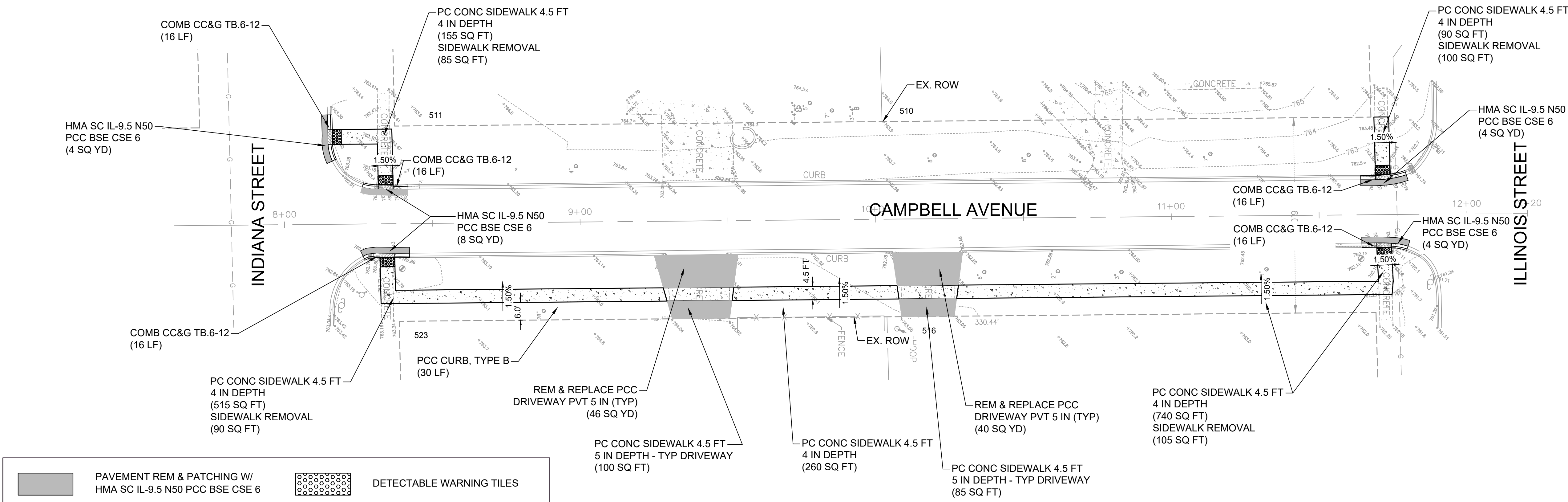

	PAVEMENT REM & PATCHING W/ HMA SC IL-9.5 N50 PCC BSE CSE 6		DETECTABLE WARNING TILES
	PC CONC SIDEWALK 4 IN		DEPRESSED CURB
	BRICK PATHWAY/DRIVEWAY REM		STRUCTURE ADJUSTMENT
	HMA DRIVEWAY PVT 3 IN REM & RE-INSTALLATION		STRUCTURE RECONSTRUCTED
	PCC DRIVEWAY PVT 5 IN REM & RE-INSTALLATION		TREE REMOVAL

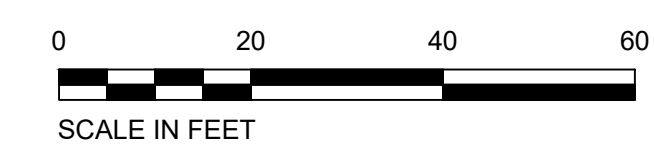
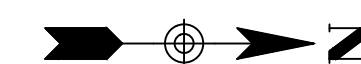
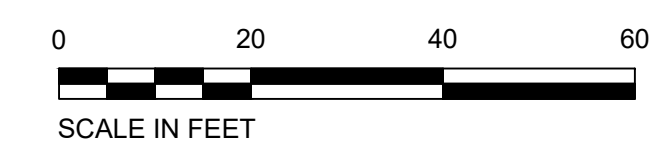
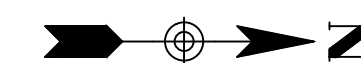
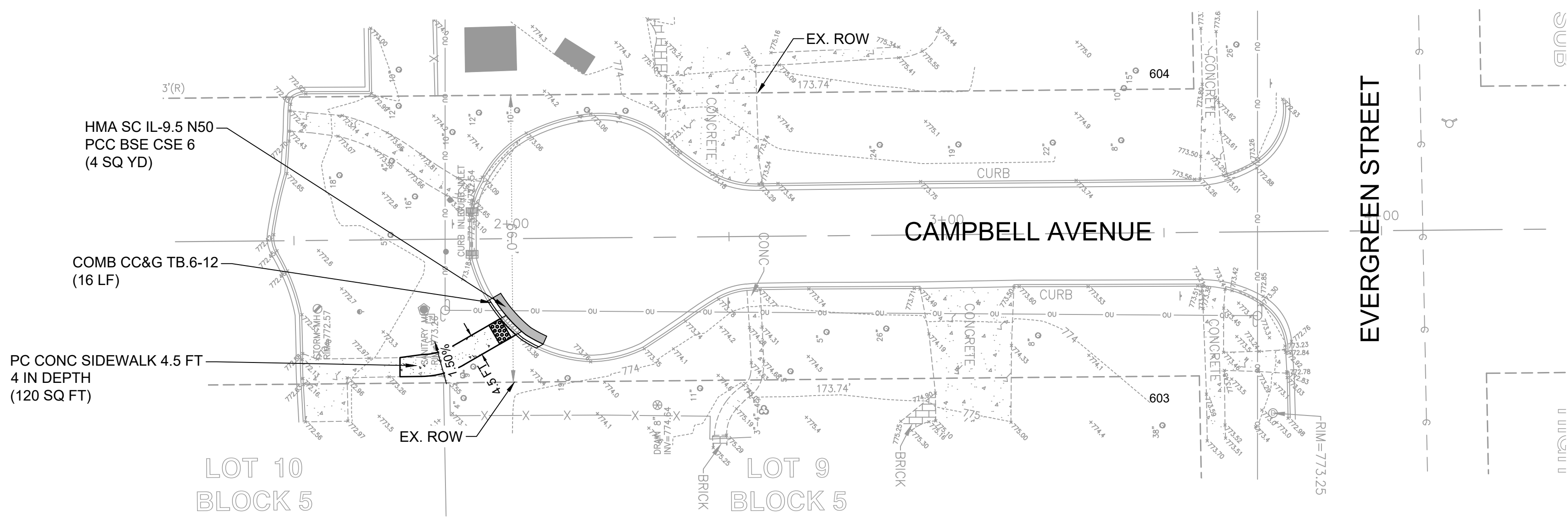

FILE NAME = \$FILES\$



USER NAME = CDENNY	DESIGNED CMD	REVISED 07/11/2023
PLOT SCALE = 1:1	DRAWN CGD	REVISED -
PLOT DATE = 05/09/2023	CHECKED CMD	REVISED -
	DATE 05/09/2023	REVISED -

WHEATON 2023 FALL SIDEWALK PROGRAM

PROPOSED PLANS CAMPBELL AVENUE

SCALE: 1" = 20' SHEET 11 OF 19 SHEETS STA. TO STA.

F.A. RTE.	SECTION	COUNTY	TOTAL SHEETS	SHEET NO.
			66	36
CONTRACT NO.				
ILLINOIS FED. AID PROJECT				